

CATÁLOGO DE INFRAESTRUTURA

DADOS TECNICOS

As informações e dados disponíveis neste catálogo foram obtidas através de estudos, análises e testes. Procuramos aliar nossa experiência para disseminar o conhecimento sobre Sistemas de Fixação para Construção Civil.



“Fixando o Presente, Segurando o Futuro”

Mitto Elementos de Fixação

*Estamos no mercado a mais de 20 anos,
desenvolvendo soluções para o seu negocio!*



www.mitto.com.br



ABRAÇADEIRAS



Abraçadeiras 4 A 9

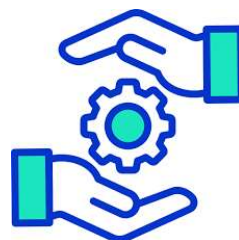

- Entender o cliente e suas expectativas
- Entender o mercado e suas tendências

ABRAÇADEIRA "U" VERGALHAO



Abraçadeira "U"..... 10



- Avaliação da viabilidade
- Avaliar o tipo de aplicação a ser executada
- Verificar as cargas incidentes e categorizá-las
- Analisar o material base e o tipo de sistema a ser empregado

CHUMBADOR PARA CONCRETO



Chumbadores 11



- Detalhamento do processo
- Desenvolvimento de protótipos
- Análise técnica do desempenho

BARRA ROSCADA



Barra rosca 12



- Ensaios de desempenho em laboratório
- Ensaios in loco

BARRA DE ANCORAGEM



Barra de ancoragem 13



- Validação do sistema pela engenharia
- Liberação pelo departamento de qualidade
- Aprovação do cliente final

GRAMPO "C" / PARAFUSO OLHAL



Grampo "C" / Parafuso olhal..... 14



- Processo de produção do Produto / Sistema
- Logística de distribuição



ABRAÇADEIRAS

ABRACH. "U" SIMPLES REFORÇADA

REINFORCED SIMPLE "U" CLAMP
ABRAZADERA "U" SIMPLE REFORZADA

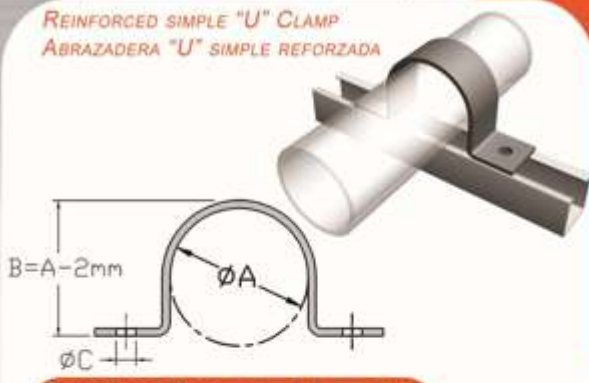

Referência Reference Referencia	Nom (Pol) Nom (Inch) Nom (Pul)	øA (mm)	øC (mm)
JUSR1/2	1/2"	24	8
JUSR3/4	3/4"	29	8
JUSR1	1"	35	8
JUSR11/4	1.1/4"	44	11
JUSR11/2	1.1/2"	51	11
JUSR2	2"	62	11
JUSR21/2	2.1/2"	75	11
JUSR3	3"	91	11
JUSR31/2	3.1/2"	104	11
JUSR4	4"	117	11
JUSR5	5"	143	14
JUSR6	6"	172	14
JUSR8	8"	223	14
JUSR10	10"	277	14
JUSR12	12"	328	14

ABRAÇADEIRA "U" SIMPLES

LIGHT SIMPLE "U" CLAMP
ABRAZADERA "U" SIMPLE LEVE

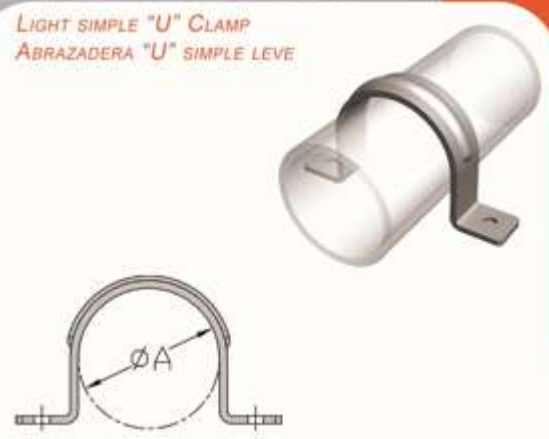

Referência Reference Referencia	Nom (Pol) Nom (Inch) Nom (Pul)	øA (mm)
JUS3/8	3/8"	19
JUS1/2	1/2"	24
JUS3/4	3/4"	29
JUS1	1"	35
JUS11/4	1.1/4"	44
JUS11/2	1.1/2"	51
JUS2	2"	62
JUS21/2	2.1/2"	75
JUS3	3"	91
JUS31/2	3.1/2"	104
JUS4	4"	117

ABRAÇADEIRA UNHA REFORÇADA

REINFORCED NAIL CLAMP
ABRAZADERA UNHA REFORZADA



Ex. de aplicação
em perfilado

Referência Reference Referencia	Nom (Pol) Nom (Inch) Nom (Pul)	øA (mm)	øC (mm)
JUNR3/8	3/8"	19	8
JUNR1/2	1/2"	24	8
JUNR3/4	3/4"	29	8
JUNR1	1"	35	8
JUNR11/4	1.1/4"	44	11
JUNR11/2	1.1/2"	51	11
JUNR2	2"	62	11
JUNR21/2	2.1/2"	75	11
JUNR3	3"	91	11
JUNR31/2	3.1/2"	104	11
JUNR4	4"	117	11



Ex. de aplicação
em cantos

ABRAÇADEIRA UNHA SIMPLES

SIMPLE NAIL CLAMP
ABRAZADERA UNHA SIMPLE



Referência Reference Referencia	Nom (Pol) Nom (Inch) Nom (Pul)	øA (mm)
JUNS3/8	3/8"	19
JUNS1/2	1/2"	24
JUNS3/4	3/4"	29
JUNS1	1"	35
JUNS11/4	1.1/4"	44
JUNS11/2	1.1/2"	51
JUNS2	2"	62



ABRAÇADEIRAS

ABRAÇADEIRA "D"

"D" CLAMP - ABRAZADERA "D"



INCLUSO PARAFUSOS E PORCAS
bolts and nuts included
incluye tornillos y tuercas

Referência	Nom (Pol)	ØA
Reference	Nom (Inch)	(mm)
Referencia	Nom (Pul)	
JBD3/8	3/8"	19
JBD1/2	1/2"	24
JBD3/4	3/4"	29
JBD1	1"	35
JBD11/4	1.1/4"	44
JBD11/2	1.1/2"	51
JBD2	2"	62
JBD21/2	2.1/2"	75
JBD3	3"	91
JBD31/2	3.1/2"	104
JBD4	4"	117

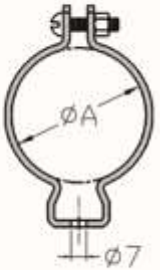

ABRAÇADEIRA "D" COM CUNHA

CLAMP "D" WITH WEDGE
ABRAZADERA "D" CON CUNHA

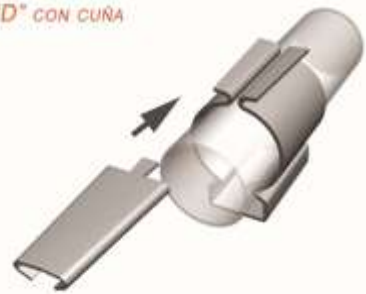

Referência	Nom (Pol)	ØA
Reference	Nom (Inch)	(mm)
Referencia	Nom (Pul)	
JDC1/2	1/2"	24
JDC3/4	3/4"	29
JDC1	1"	35
JDC11/4	1.1/4"	44
JDC11/2	1.1/2"	51
JDC2	2"	62
JDC21/2	2.1/2"	75
JDC3	3"	91
JDC31/2	3.1/2"	104
JDC4	4"	117

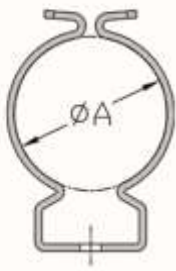

ABRAÇADEIRA GOTA

DROP CLAMP
ABRAZADERA GOTA



Referência	Nom (Pol)	ØA	ØC	CARGA KG
Reference	Nom (Inch)	(mm)	(mm)	Kg
Referencia	Nom (Pul)			
JBG3/8	3/8"	19	11	100
JBG1/2	1/2"	24	11	100
JBG3/4	3/4"	29	11	100
JBG1	1"	35	11	150
JBG11/4	1.1/4"	44	11	150
JBG11/2	1.1/2"	51	11	150
JBG2	2"	62	11	150
JBG21/2	2.1/2"	75	14	200
JBG3	3"	91	14	200
JBG31/2	3.1/2"	104	14	200
JBG4	4"	117	14	200
JBG5	5"	143	14	200
JBG6	6"	172	14	300
JBG8	8"	223	14	300
JBG10	10"	277	14	400
JBG12	12"	328	14	400

ABRAÇADEIRA "U" PERFIL

"U" CLAMP PROFILE
ABRAZADERA "U" PERFIL

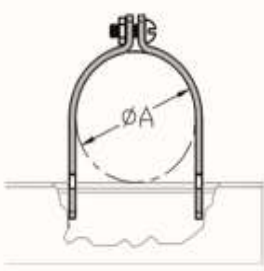

Referência	Nom (Pol)	ØA
Reference	Nom (Inch)	(mm)
Referencia	Nom (Pul)	
JUP3/8	3/8"	19
JUP1/2	1/2"	24
JUP3/4	3/4"	29
JUP1	1"	35
JUP11/4	1.1/4"	44
JUP11/2	1.1/2"	51
JUP2	2"	62
JUP21/2	2.1/2"	75
JUP3	3"	91
JUP31/2	3.1/2"	104
JUP4	4"	117

ABRAÇADEIRAS

Referência	Nom (Pol)	øA	B	C	E(POL) x L(POL)	H
Reference	Nom (Inch)	(mm)	(mm)	(mm)	E(Inch) x L(Inch)	(mm)
Referência	Nom (Pul)				E(pul) x L(pul)	
JT4UB1/2	1/2"	24	140	108	3/16" x 1.1/4"	17
JT4UB3/4	3/4"	29	140	108	3/16" x 1.1/4"	19,5
JT4UB1	1"	35	140	108	3/16" x 1.1/4"	22,5
JT4UB11/4	1.1/4"	44	140	108	3/16" x 1.1/4"	27
JT4UB11/2	1.1/2"	51	140	108	3/16" x 1.1/4"	30,5
JT4UB2	2"	62	140	108	3/16" x 1.1/4"	36
JT4UB21/2	2.1/2"	75	220	182	1/4" x 1.1/2"	44
JT4UB3	3"	91	220	182	1/4" x 1.1/2"	52
JT4UB31/2	3.1/2"	104	220	182	1/4" x 1.1/2"	58,5
JT4UB4	4"	117	220	182	1/4" x 1.1/2"	65
JT4UB5	5"	143	300	262	1/4" x 1.1/2"	78
JT4UB6	6"	172	300	262	1/4" x 1.1/2"	92,5
JT4UB8	8"	223	400	362	1/4" x 1.1/2"	118
JT4UB10	10"	277	400	362	1/4" x 1.1/2"	145
JT4UB12	12"	328	400	362	1/4" x 1.1/2"	170,5

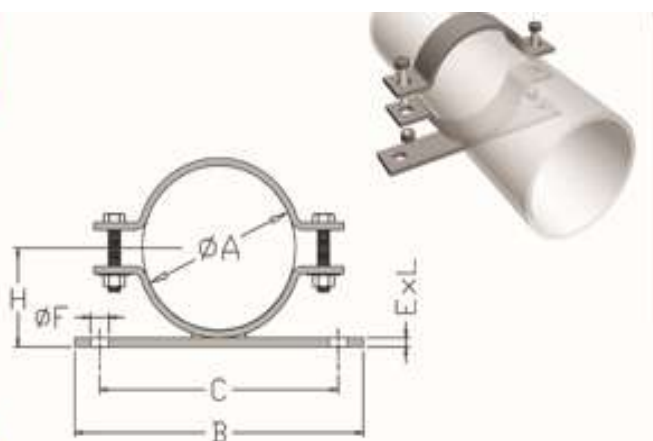

Referência	Nom (Pol)	øA	B	C	E(POL) x L(POL)	H1
Reference	Nom (Inch)	(mm)	(mm)	(mm)	E(Inch) x L(Inch)	(mm)
Referência	Nom (Pul)				E(pul) x L(pul)	
JT5UB1/2	1/2"	24	140	108	3/16" x 1.1/4"	48,5
JT5UB3/4	3/4"	29	140	108	3/16" x 1.1/4"	53
JT5UB1	1"	35	140	108	3/16" x 1.1/4"	57,5
JT5UB11/4	1.1/4"	44	140	108	3/16" x 1.1/4"	63
JT5UB11/2	1.1/2"	51	140	108	3/16" x 1.1/4"	67,5
JT5UB2	2"	62	140	108	3/16" x 1.1/4"	73,5
JT5UB21/2	2.1/2"	75	220	182	1/4" x 1.1/2"	90
JT5UB3	3"	91	220	182	1/4" x 1.1/2"	101
JT5UB31/2	3.1/2"	104	220	182	1/4" x 1.1/2"	108,5
JT5UB4	4"	117	220	182	1/4" x 1.1/2"	116
JT5UB5	5"	143	300	262	1/4" x 1.1/2"	130
JT5UB6	6"	172	300	262	1/4" x 1.1/2"	146
JT5UB8	8"	223	400	362	1/4" x 1.1/2"	172,5
JT5UB10	10"	277	400	362	1/4" x 1.1/2"	200
JT5UB12	12"	328	400	362	1/4" x 1.1/2"	226

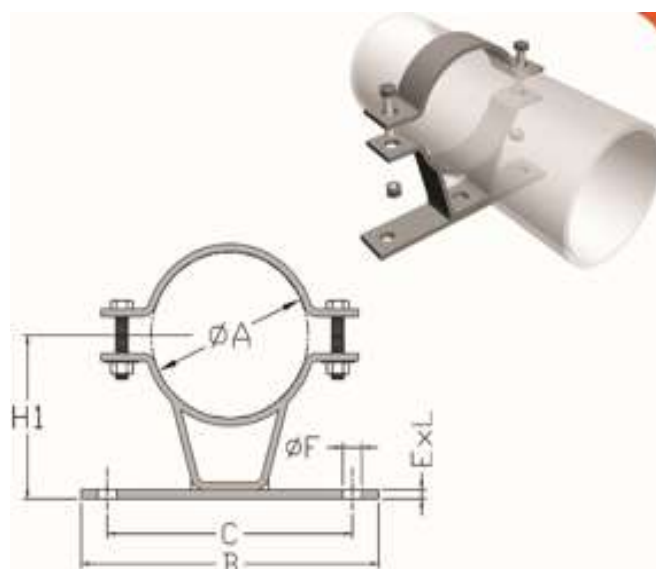

Referência	Nom (Pol)	øA	B	C	E(POL) x L(POL)	H2
Reference	Nom (Inch)	(mm)	(mm)	(mm)	E(Inch) x L(Inch)	(mm)
Referência	Nom (Pul)				E(pul) x L(pul)	
JT6UB1/2	1/2"	24	140	108	3/16" x 1.1/4"	67
JT6UB3/4	3/4"	29	140	108	3/16" x 1.1/4"	69,5
JT6UB1	1"	35	140	108	3/16" x 1.1/4"	72,5
JT6UB11/4	1.1/4"	44	140	108	3/16" x 1.1/4"	77
JT6UB11/2	1.1/2"	51	140	108	3/16" x 1.1/4"	80,5
JT6UB2	2"	62	140	108	3/16" x 1.1/4"	86
JT6UB21/2	2.1/2"	75	220	182	1/4" x 1.1/2"	94
JT6UB3	3"	91	220	182	1/4" x 1.1/2"	102
JT6UB31/2	3.1/2"	104	220	182	1/4" x 1.1/2"	108,5
JT6UB4	4"	117	220	182	1/4" x 1.1/2"	115
JT6UB5	5"	143	300	262	1/4" x 1.1/2"	128
JT6UB6	6"	172	300	262	1/4" x 1.1/2"	142,5
JT6UB8	8"	223	400	362	1/4" x 1.1/2"	168
JT6UB10	10"	277	400	362	1/4" x 1.1/2"	195
JT6UB12	12"	328	400	362	1/4" x 1.1/2"	220,5

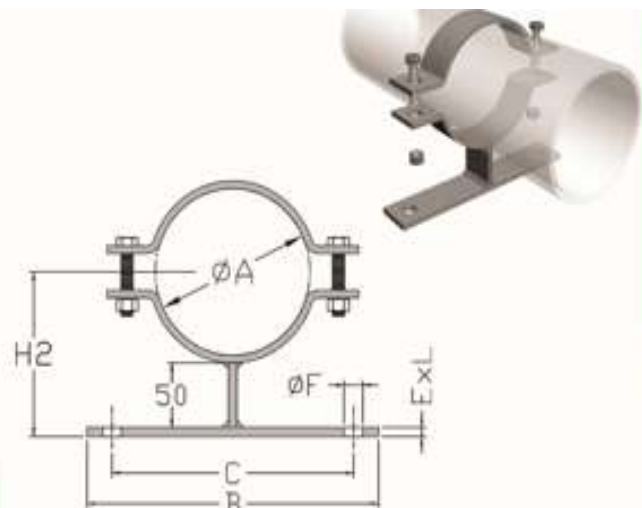

ABRAÇADEIRAS

HARD UNION CLAMP FOR K-9 F°F° PIPE
ABRAZADERA UNIÓN PESADA PARA TUBO K-9 F°F°



INCLUSO PARAFUSOS E PORCAS
bolts and nuts included
incluye tornillos y tuercas

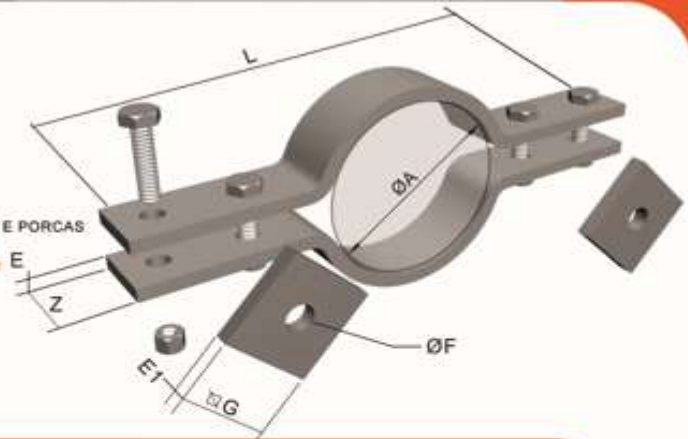

Referência Reference Referencia	Abraçadeira Clamp - Abrazadera				Arruela Washer - arandela			Parafuso Bolt - Tornillo		Tirante Threaded Bar Barra	
	ØTubo	ØA (mm)	L (mm)	E(POL) x Z(MM) E(Inch) x Z(mm) E(pul) x Z(mm)	G (mm)	E1 (POL)	ØF (mm)	ØP x COMP ØP x Width ØP x Comp			Ø(POL)
JT7 UP 100	4"	116	390	1/2" x 2"	76	1/2"	22	5/8" x 2.1/2"			3/4"
JT7 UP 150	6"	172	450	1/2" x 2"	76	1/2"	22	5/8" x 2.1/2"			3/4"
JT7 UP 200	8"	220	506	5/8" x 2.1/2"	76	1/2"	22	5/8" x 3"			3/4"
JT7 UP 250	10"	267	556	5/8" x 2.1/2"	76	1/2"	25	3/4" x 3"			7/8"
JT7 UP 300	12"	323	616	5/8" x 3"	89	1/2"	28	7/8" x 3.1/2"			1"

HARD UNION CLAMP FOR BAG K-9 F°F° PIPE
ABRAZADERA UNIÓN PESADA PARA BOLSO TUBO K-9 F°F°



INCLUSO PARAFUSOS E PORCAS
bolts and nuts included
incluye tornillos y tuercas

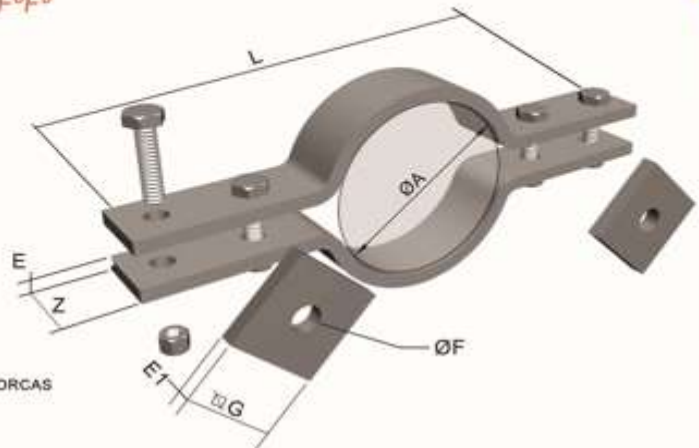

Referência Reference Referencia	Abraçadeira Clamp - Abrazadera				Arruela Washer - arandela			Parafuso Bolt - Tornillo		Tirante Threaded Bar Barra	
	ØTubo	ØA (mm)	L (mm)	E(POL) x Z(MM) E(Inch) x Z(mm) E(pul) x Z(mm)	G (mm)	E1 (POL)	ØF (mm)	ØP x COMP ØP x Width ØP x Comp			Ø(POL)
JT7 UPB 100	4"	172	450	1/2" x 2"	76	1/2"	22	5/8" x 2.1/2"			3/4"
JT7 UPB 150	6"	220	502	1/2" x 2"	76	1/2"	22	5/8" x 2.1/2"			3/4"
JT7 UPB 200	8"	262	552	5/8" x 2.1/2"	76	1/2"	22	5/8" x 3"			3/4"
JT7 UPB 250	10"	323	614	5/8" x 2.1/2"	76	1/2"	25	3/4" x 3"			7/8"
JT7 UPB 300	12"	380	644	5/8" x 3"	89	1/2"	28	7/8" x 3.1/2"			1"

ABRAÇADEIRAS

T2 VERTICAL CLAMP

ABRAZADERA UNIÓN VERTICAL T2

Referência Reference Referencia	Nom (Pol) Nom (Inch) Nom (Pul)	øA (mm)	øB (mm)	C (mm)	E(POL) x L(MM) E(Inch) x L(mm) E(pul) x L(mm)
JT2UVL1/2	1/2"	24	9,5	73	1/2"x25
JT2UVL3/4	3/4"	29	9,5	73	1/8"x25
JT2UVL1	1"	35	9,5	73	1/8"x25
JT2UVL1.1/4	1.1/4"	44	9,5	73	1/8"x25
JT2UVL1.1/2	1.1/2"	51	9,5	73	1/8"x25
JT2UVL2	2"	62	9,5	73	1/8"x25
JT2UVL2.1/2	2.1/2"	75	11	80	3/16" x 32
JT2UVL3	3"	91	11	80	3/16" x 32
JT2UVL3.1/2	3.1/2"	104	11	80	3/16" x 32
JT2UVL4	4"	117	11	80	3/16" x 32



Linha LEVE

LIGHT Line

Linea LIGERO

Referência Reference Referencia	Nom (Pol) Nom (Inch) Nom (Pul)	øA (mm)	øB (mm)	C (mm)	E(POL) x L(MM) E(Inch) x L(mm) E(pul) x L(mm)
JT2UV1/2	1/2"	24	11	85	3/16" x 32
JT2UV3/4	3/4"	29	11	85	3/16" x 32
JT2UV1	1"	35	11	85	3/16" x 32
JT2UV1.1/4	1.1/4"	44	11	85	3/16" x 32
JT2UV1.1/2	1.1/2"	51	11	85	3/16" x 32
JT2UV2	2"	62	11	85	3/16" x 32
JT2UV2.1/2	2.1/2"	75	14	100	1/4" x 38
JT2UV3	3"	91	14	100	1/4" x 38
JT2UV3.1/2	3.1/2"	104	14	100	1/4" x 38
JT2UV4	4"	117	14	100	1/4" x 38
JT2UV5	5"	143	14	110	1/4" x 38
JT2UV6	6"	172	14	110	1/4" x 38
JT2UV8	8"	223	14	110	1/4" x 38
JT2UV10	10"	277	14	110	1/4" x 38
JT2UV12	12"	328	14	110	1/4" x 38

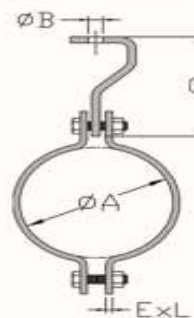

Linha PESADA

HEAVY Line

Linea PESADA

T3 VERTICAL CLAMP

ABRAZADERA VERTICAL T3

Referência Reference Referencia	Nom (Pol) Nom (Inch) Nom (Pul)	øA (mm)	E(POL) x L(MM) E(Inch) x L(mm) E(pul) x L(mm)
JT3V1/2	1/2"	24	3/16" x 32
JT3V3/4	3/4"	29	3/16" x 32
JT3V1	1"	35	3/16" x 32
JT3V11/4	1.1/4"	44	3/16" x 32
JT3V11/2	1.1/2"	51	3/16" x 32
JT3V2	2"	62	3/16" x 32
JT3V21/2	2.1/2"	75	1/4" x 38
JT3V3	3"	91	1/4" x 38
JT3V31/2	3.1/2"	104	1/4" x 38
JT3V4	4"	117	1/4" x 38
JT3V5	5"	143	1/4" x 38
JT3V6	6"	172	1/4" x 38
JT3V8	8"	223	1/4" x 38
JT3V10	10"	277	1/4" x 38
JT3V12	12"	238	1/4" x 38

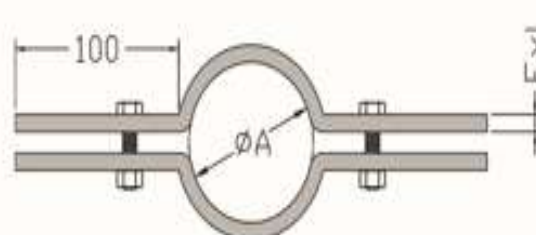



ABRAÇADEIRAS

SUPORE PENDURAL

KINGPOST SUPPORT
SOPORTE PENDURAL

Referência	Nom (Pol)	øA	øC	Carga	E(POL) x L(MM)
Reference	Nom (Inch)	(mm)	(mm)	Charge	E(Inch) x L(mm)
Referencia	Nom (Pul)			Carga	E(pul) x L(mm)
JSP1/2	1/2"	24	11	200	1/8" x 25
JSP3/4	3/4"	29	11	200	1/8" x 25
JSP1	1"	35	11	200	1/8" x 25
JSP11/4	1.1/4"	44	11	200	1/8" x 25
JSP11/2	1.1/2"	51	11	200	1/8" x 25
JSP2	2"	62	11	300	3/16" x 32
JSP21/2	2.1/2"	75	14	300	3/16" x 32
JSP3	3"	91	14	300	3/16" x 32
JSP31/2	3.1/2"	104	14	300	3/16" x 32
JSP4	4"	117	14	300	3/16" x 32
JSP5	5"	143	14	500	1/4" x 38
JSP6	6"	172	14	500	1/4" x 38
JSP8	8"	223	14	500	1/4" x 38
JSP10	10"	277	14	800	5/16" x 50
JSP12	12"	328	14	800	5/16" x 50

NÃO Incluso!

NOT included!
NO incluido!

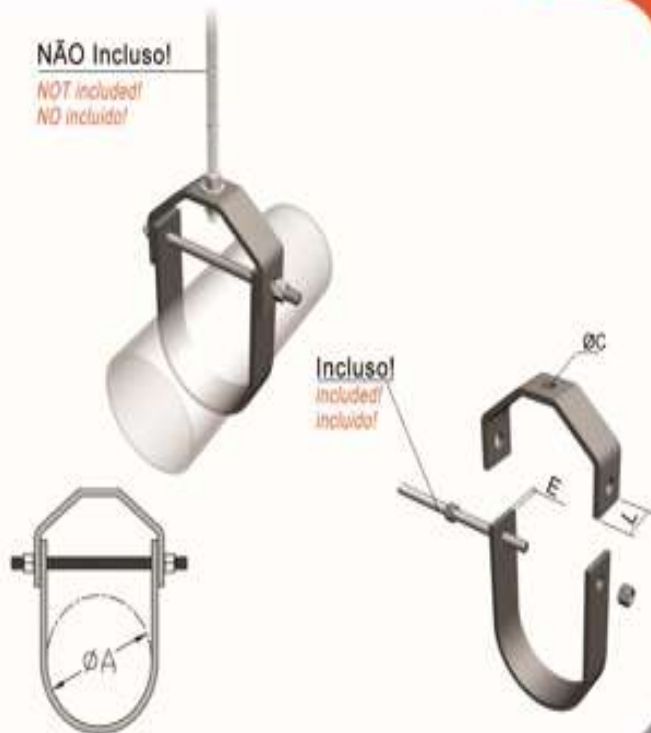

ABRAÇADEIRA UNIÃO HORIZONTAL T1

T1 HORIZONTAL CLAMP
ABRAZADERA UNIÓN HORIZONTAL T1

Referência	Nom (Pol)	øA	øB	C	E(POL) x L(MM)
Reference	Nom (Inch)	(mm)	(mm)	(mm)	E(Inch) x L(mm)
Referencia	Nom (Pul)				E(pul) x L(mm)
JT1UHL1/2	1/2"	24	9,5	26	1/2"x25
JT1UHL3/4	3/4"	29	9,5	26	1/8"x25
JT1UHL1	1"	35	9,5	28	1/8"x25
JT1UHL1.1/4	1.1/4"	44	9,5	30	1/8"x25
JT1UHL1.1/2	1.1/2"	51	9,5	30	1/8"x25
JT1UHL2	2"	62	9,5	31	1/8"x25
JT1UHL2.1/2	2.1/2"	75	11	40	3/16" x 32
JT1UHL3	3"	91	11	40	3/16" x 32
JT1UHL3.1/2	3.1/2"	104	11	42	3/16" x 32
JT1UHL4	4"	117	11	43	3/16" x 32



Linha LEVE

LIGHT Line
Línea LIGERO

Referência	Nom (Pol)	øA	øB	C	E(POL) x L(MM)
Reference	Nom (Inch)	(mm)	(mm)	(mm)	E(Inch) x L(mm)
Referencia	Nom (Pul)				E(pul) x L(mm)
JT1UH1/2	1/2"	24	11	33	3/16" x 32
JT1UH3/4	3/4"	29	11	33	3/16" x 32
JT1UH1	1"	35	11	35	3/16" x 32
JT1UH1.1/4	1.1/4"	44	11	35	3/16" x 32
JT1UH1.1/2	1.1/2"	51	11	35	3/16" x 32
JT1UH2	2"	62	11	38	3/16" x 32
JT1UH2.1/2	2.1/2"	75	14	45	1/4" x 38
JT1UH3	3"	91	14	45	1/4" x 38
JT1UH3.1/2	3.1/2"	104	14	48	1/4" x 38
JT1UH4	4"	117	14	50	1/4" x 38
JT1UH5	5"	143	14	52	1/4" x 38
JT1UH6	6"	172	14	52	1/4" x 38
JT1UH8	8"	223	14	55	1/4" x 38
JT1UH10	10"	277	14	55	1/4" x 38
JT1UH12	12"	328	14	55	1/4" x 38

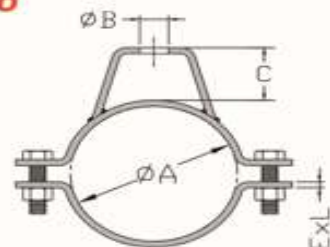

Linha PESADA

HEAVY Line
Línea PESADA

ABRAÇADEIRAS "U"

Referência Reference Referencia	øA (Pol) (Inch) (Pul)	B (mm)	C (mm)	øD (Pol) (Inch) (Pul)
JUVEP1/2x1/4	1/2"	24	40	1/4"
JUVEP3/4x1/4	3/4"	29	40	1/4"
JUVEP1x1/4	1"	35	40	1/4"
JUVEP11/2x1/4	1.1/2"	51	40	1/4"
JUVEP2x1/4	2"	62	40	1/4"
JUVEP21/2x3/8	2.1/2"	63	40	3/8"
JUVEP3x3/8	3"	90	40	3/8"
JUVEP4x3/8	4"	116	40	3/8"
JUVEP6x1/2	6"	171	45	1/2"
JUVEP8x1/2	8"	222	45	1/2"
JUVEP10x3/4	10"	276	55	3/4"
JUVEP12x3/4	12"	327	55	3/4"
JUVEP14x3/4	14"	359	55	3/4"

Materiais Fornecidos:

Materials Provided

Materiales suministrados:

SAE 4140

INOX 304, 316, 321, 410

INCONEL 625 E 718

DUPLEX

SUPER DUPLEX

(Outros, sob consulta)

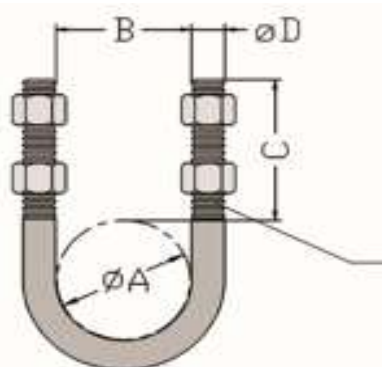

Também Vulcanizado !
Also Vulcanized!
También vulcanizada!

Tipos de Revestimentos:

Types of coatings

Tipos de revestimientos:

CADMIO BICROMATIZADO

ZINCO NÍQUEL

FOSFATIZADO

OXIDADO NEGRO

XYLAN

ZINCO BRANCO

(Outros, sob consulta)

Referência Reference Referencia	Nom (Pol) Nom (Inch) Nom (Pul)	øA (mm)	B (mm)	C (mm)	øD (POL) øD (inch) øD (pul)	CARGA KG Charge Carga
JUV1/2x5/16	1/2"	24	45	70	5/16"	200
JUV3/4x5/16	3/4"	29	45	70	5/16"	200
JUV1x5/16	1"	35	45	85	5/16"	200
JUV11/4x5/16	1.1/4"	44	45	90	5/16"	200
JUV11/2x5/16	1.1/2"	51	45	98	5/16"	200
JUV2x3/8	2"	62	55	120	3/8"	250
JUV21/2x3/8	2.1/2"	75	55	130	3/8"	250
JUV3x3/8	3"	91	55	145	3/8"	250
JUV31/2x3/8	3.1/2"	104	55	160	3/8"	250
JUV4x3/8	4"	117	55	180	3/8"	250
JUV5x1/2	5"	143	105	240	1/2"	300
JUV6x5/8	6"	172	110	270	5/8"	500
JUV8x5/8	8"	223	110	320	5/8"	500
JUV10x3/4	10"	277	120	377	3/4"	700
JUV12x3/4	12"	328	120	430	3/4"	700
JUV14x3/4	14"	366	120	460	3/4"	700
JUV16x3/4	16"	420	120	510	3/4"	700
JUV18x3/4	18"	470	120	560	3/4"	700
JUV20x3/4	20"	525	120	615	3/4"	700
JUV22x7/8	22"	575	150	690	7/8"	900
JUV24x7/8	24"	630	150	740	7/8"	900
JUV26x7/8	26"	680	150	790	7/8"	900
JUV28x7/8	28"	730	150	840	7/8"	900
JUV30x7/8	30"	780	150	900	7/8"	900
JUV32x7/8	32"	830	150	950	7/8"	900
JUV34x7/8	34"	880	150	1000	7/8"	900

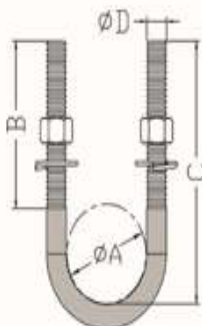



CHUMBADOR

"J" ANCHOR BOLT FOR CONCRETE
PERNO DE ANLAJE "J"

$R = \phi A \times 2,5$
 $S = \phi A \times 3$

Referência	ØA (Pol)	P (mm)	T (mm)
JCJC 3/8	3/8"	80	260
JCJC 1/2	1/2"	100	320
JCJC 5/8	5/8"	100	400
JCJC 3/4	3/4"	120	500
JCJC 7/8	7/8"	120	600
JCJC 1	1"	120	750
JCJC 1.1/8	1.1/8"	150	900
JCJC 1.1/4	1.1/4"	150	1100
JCJC 1.3/8	1.3/8"	200	1300
JCJC 1.1/2	1.1/2"	200	1500
JCJC 2	2"	250	1800

"L" ANCHOR BOLT FOR CONCRETE
PERNO DE ANLAJE "L"

$D = \phi A \times 6$

Referência	ØA (Pol)	P (mm)	T (mm)
JCLC 3/8	3/8"	80	260
JCLC 1/2	1/2"	100	320
JCLC 5/8	5/8"	100	400
JCLC 3/4	3/4"	120	500
JCLC 7/8	7/8"	120	600
JCLC 1	1"	120	750
JCLC 1.1/8	1.1/8"	150	900
JCLC 1.1/4	1.1/4"	150	1100
JCLC 1.3/8	1.3/8"	200	1300
JCLC 1.1/2	1.1/2"	200	1500
JCLC 2	2"	250	1800

"P" ANCHOR BOLT FOR CONCRETE
PERNO DE ANLAJE "P"

$C = \phi A \times 6$
 $E = \phi A \times 0,7$

Referência	ØA (Pol)	P (mm)	T (mm)
JCPC 3/8	3/8"	80	260
JCPC 1/2	1/2"	100	320
JCPC 5/8	5/8"	100	400
JCPC 3/4	3/4"	120	500
JCPC 7/8	7/8"	120	600
JCPC 1	1"	120	750
JCPC 1.1/8	1.1/8"	150	900
JCPC 1.1/4	1.1/4"	150	1100
JCPC 1.3/8	1.3/8"	200	1300
JCPC 1.1/2	1.1/2"	200	1500
JCPC 2	2"	250	1800

"I" ANCHOR BOLT N-134 PETROBRAS
PERNO DE ANLAJE "I" N-134 PETROBRAS

Ø : M27, M30, M33, M36, M42, M48, M56, M64, M72, M80, M90, M100

Referência

Ø : M10, M12, M16, M20, M22, M24, M27, M30



BARRA ROSCADA

BARRA ROSCADA TOTAL

FULLY-THREADED BAR
BARRA TOTALMENTE ROSCADA



Acabamento Galvanizado G.E.
Electrolytic Galvanization;
Galvanización Electrolítica:

Referência Reference Referencia	Ø (Pol)
JBR1/4X3G	1/4"
JBR5/16X3G	5/16"
JBR3/8X3G	3/8"
JBR1/2X3G	1/2"
JBR5/8X3G	5/8"
JBR3/4X3G	3/4"

BARRA ROSCADA DE 1 METRO

1 METER THREADED BAR
BARRA ROSCADA 1METRO



Galvanizado G.E.
Electrolytic Galvanization;
Galvanización Electrolítica:

Referência Reference Referencia	Ø (Pol)
JBR 5/32	5/32"
JBR 3/16	3/16"
JBR 1/4	1/4"
JBR 5/16	5/16"
JBR 3/8	3/8"
JBR 7/16	7/16"
JBR 1/2	1/2"
JBR 9/16	9/16"
JBR 5/8	5/8"
JBR 3/4	3/4"
JBR 7/8	7/8"
JBR 1	1"
JBR 1.1/8	1.1/8"
JBR 1.1/4	1.1/4"
JBR 1.3/8	1.3/8"
JBR 1.1/2	1.1/2"
JBR 1.3/4	1.3/4"
JBR 2	2"

Referência Reference Referencia	Ø (mm)
JBRM4	M4
JBRM5	M5
JBRM6	M6
JBRM8	M8
JBRM10	M10
JBRM12	M12
JBRM14	M14
JBRM16	M16
JBRM18	M18
JBRM20	M20
JBRM22	M22
JBRM24	M24
JBRM27	M27
JBRM30	M30
JBRM33	M33
JBRM36	M36
JBRM42	M42
JBRM48	M48

HASTE PARA TELHA

TILE ROD
HASTE PARA TEJA



Referência Reference Referencia	L (MM)
JHT1/4x150	150
JHT1/4x200	200
JHT1/4x250	250
JHT1/4x300	300
JHT1/4x350	350
JHT1/4x400	400
JHT1/4x450	450
JHT1/4x500	500
JHT1/4x550	550
JHT1/4x600	600



BARRA DE ANCORAGEM

BARRA DE ANCORAGEM

TIE BAR
BARRA DE ANCLAJE

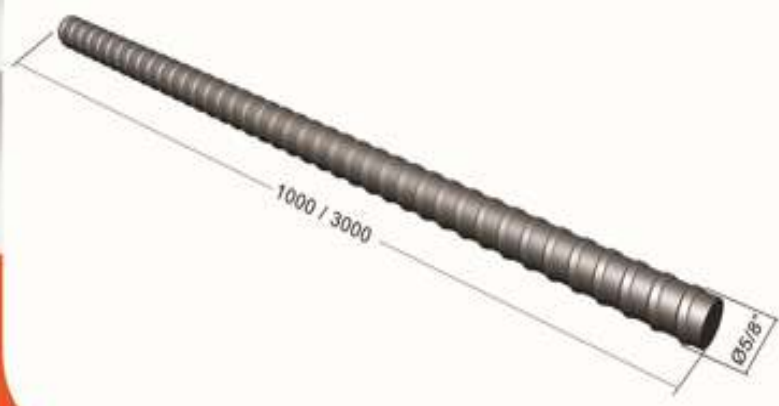

5/8"x1000



5/8"x3000



PORCA DE ANCORAGEM

TIE NUT
TUERCA DE ANCLAJE



ARRUELA QUADRADA DE ANCORAGEM

SQUARE TIE WASHER
ARANDELA CUADRADA DE ANCLAJE

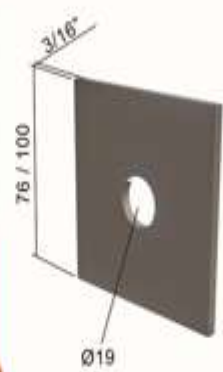

3/16"x3"x3
(76x76)



3/16"x4"x4"
(100x100)



TIPOS DE MONTAGEM

TYPES OF ASSEMBLY
TIPOS DE MONTAJE

CONJUNTO DE ANCORAGEM COM BASE SOLDADA

SET OF TIE WITH DOUBLE SQUEEZE
CONJUNTO DE ANCLAJE CON DOBLE APRIETE

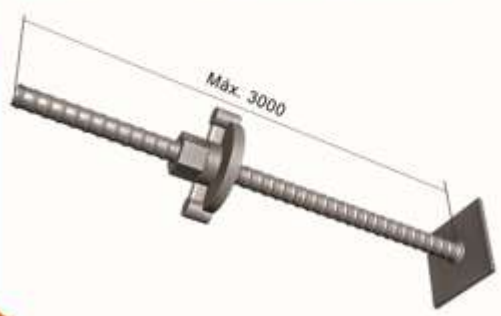

CONJUNTO DE ANCORAGEM COM DUPLO APERTO

SET OF TIE BASED WELDED
CONJUNTO DE ANCLAJE CON SOLDADURA EN LA BASE

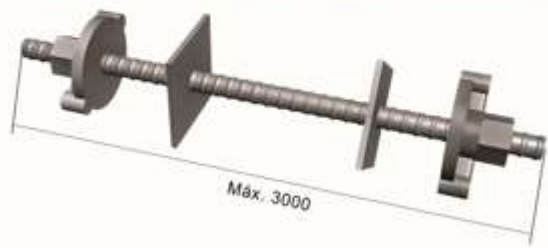



GRAMPO "C"

Grampo 3/8 A 1/2



NÃO recomendamos utilizar nesta posição !
NOT recommend use this position!
NO recomendamos utilizar esta posición!

Usos corretos!
Use correct!
Usos correctos!



PARAFUSO OLHAL

SOCKET-SCREW
TORNILLO DE OJAL

Referência Reference Referencia	Ø (Pol)	ØA (MM)
JPO1/4	1/4"	13
JPO5/16	5/16"	13
JPO3/8	3/8"	18
JPS1/2	1/2"	21



Fale Conosco:

E-mails:

vendas.enio@mitto.com.br
keivison.dias@mitto.com.br

Telefones:

Enio: 31 99605 - 7305 

Keivison: 31 99321 - 7005 

www.mitto.com.br

